

MICRO SWITCHES

DIMENSIONS

Unless otherwise specified, a tolerance of $\pm 0.4\text{mm}$ applies to all dimensions.

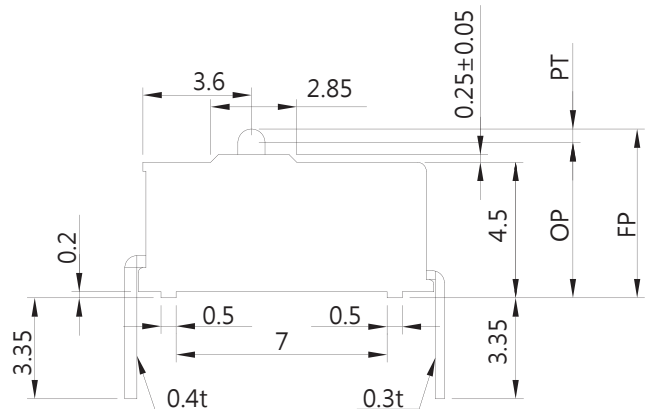
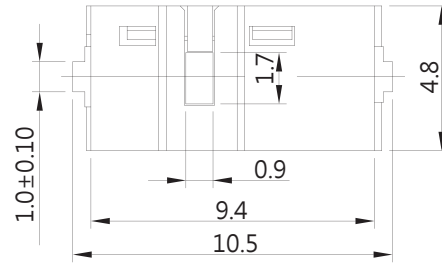
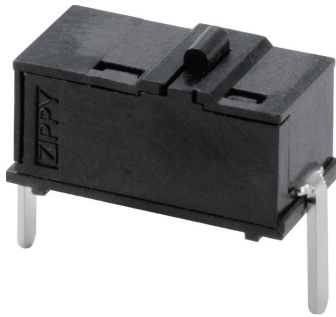

DS SERIES

SPECIFICATIONS

Contact Resistance(initial)

Max. 800 m Ω

Measured by ohm meter - open voltage < 1VDC, driver current -100 mA

Insulation Resistance(at 250 VDC / minute)

Min. 100 M Ω

Dielectric Strength

Min. 250VAC(50-60HZ)/minute between Live-parts and dead metal parts

Operating Temperature Range

-40°C to 85°C (with no icing)

Vibration

10~55Hz, displacement 0.75 mm (p-p)

Electrical Service Life

Min.1,000,000 operations

Electrical Operating Frequency

120 operations per minute

Mechanical Service Life

Min. 3,000,000 operations

Mechanical Operating Frequency

120 operations per minute

Operating application of the switch

Set the switch pushing distance from 60% to 90% of the specified OT value

CONTACT CONFIGURATION

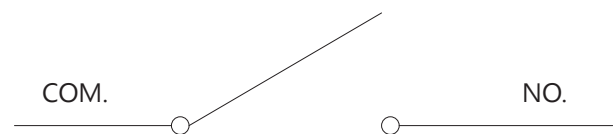

RATING

0.1A 125VAC, 0.1A 48VDC,

50mA 12VDC

APPLICATIONS

Mouse, Joystick

MOUNTING HOLES

P Type Terminal

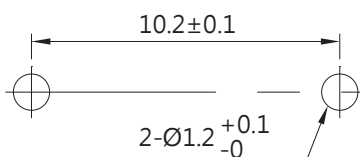

D Type Terminal

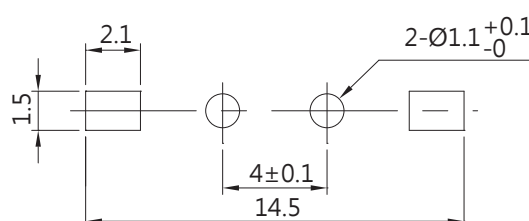

R · L Type Terminal

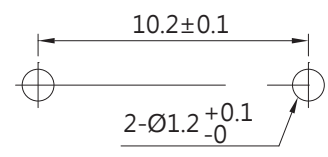

TERMINAL TYPES

P TYPE

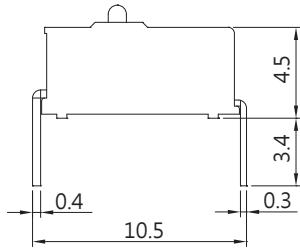

D TYPE

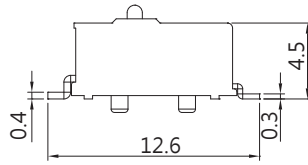

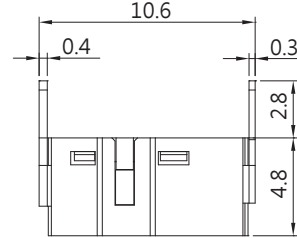

L TYPE

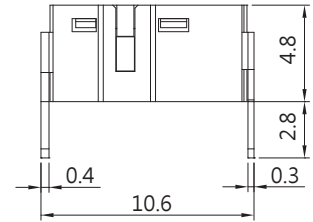

R TYPE

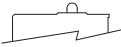
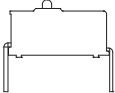

ORDERING INFORMATION

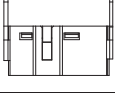
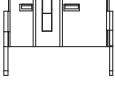
D	S	-	P	1		L	-	0	0		P	-	Z	
SERIES PREFIX			RATING CURRENT			OPERATING FORCE		BUTTON TYPE			TERMINAL TYPE		ROHS CODE	
P1			0.1A 48VDC			L	75±25gf				P			
						S	MAX. 150g				D			
											L			
											R			

OPERATING CHARACTERISTICS

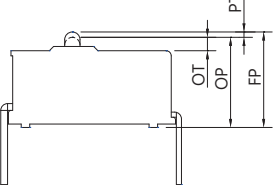
SWITCH TYPE	PART SUFFIX	OF (gf)	OP (mm)	PT Max. (mm)	OT Min. (mm)	MD Max. (mm)	RF Min. (gf)
DS-P1 □ -00 □ -Z		L	75±25	5.25±0.2	0.95	0.25	15
		S	Max.150				30